

Pacific Pines, QLD

Supported
Independent Living



House Size
4 bedrooms



Support
24/7



Bathrooms
2 bathrooms



Location
4211



Enjoy a balance of privacy and connection

About

Located in the highly sought-after, quiet neighbourhood of Pacific Pines on the Gold Coast, this beautiful home is ready for you to move in and start your new life. With two other tenants and 24-hour support staff, this is a great opportunity to increase your independence within a supportive and relaxed environment.

Available rooms

1 room available with TV connection and double wardrobe.

Current Tenants

The current tenants are two friendly males who enjoy spending time with their families and who participate in several programs in the Gold Coast community. They enjoy visiting the local shopping centres and parks, as well as hitting up their local bowling alley.

Accessibility

This property is best suited to those with minimal accessibility requirements.

Disability support

Multicap offers 24/7 support from our highly trained and friendly staff. We also encourage the participants and their families to be part of the staff selection and matching process.



1300 135 886

multicap.org.au

 **MULTICAP**
HIGH NEEDS DISABILITY SUPPORT

Enjoy the quiet life in Pacific Pines

Looking for comfort, independence, and support? Multicap's Pacific Pines accommodation offers a relaxed coastal lifestyle allowing you to enjoy life at your own pace and on your own terms.

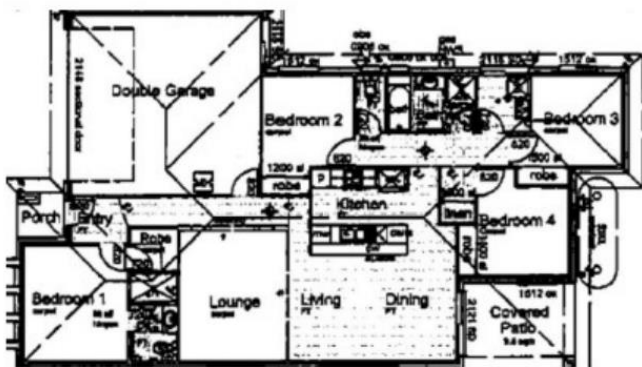

Key features

- Single level home
- Open plan kitchen and living area
- 3 private customer bedrooms
- Fourth bedroom for 24-hour support
- Large accessible kitchen and dining
- Fully fenced backyard with undercover entertaining area and BBQ
- Ceiling fans and split system air conditioning

House Lifestyle

There's plenty of room to socialize or just enjoy time to yourself. The large kitchen is perfect for joining your housemates in cooking and enjoying a delicious healthy meal together.

Ideal Applicants

If you are a friendly, social person who likes to get out and about in the community, but also enjoys having some time alone, this may be the right place for you.

Important Information

Applicants must have Supported Independent Living (SIL) eligibility.



Nearby Features

- Close to many parks including a basketball court and skate park
- 900 metres to bus stop
- 12 minute drive to Helensvale station
- 5 minute drive to Pacific Pines shopping centre
- 19 minute driver to Westfield Helensvale
- 25 minute drive to Surfers Paradise breach